

CRP

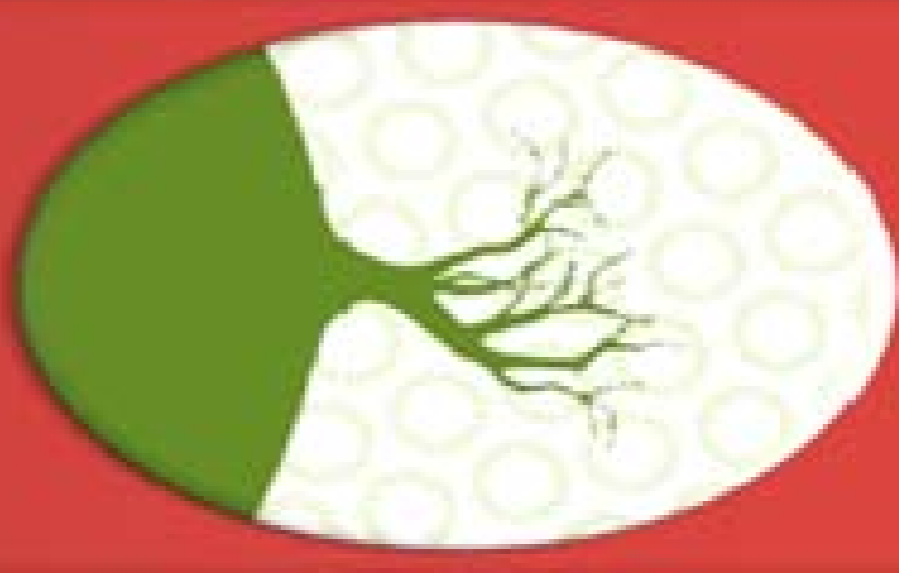

**SELLING NOW**

- On market
  - Lot 4 (539m<sup>2</sup>)
  - Lot 5 (530m<sup>2</sup>)
  - Lot 6 (538m<sup>2</sup>)
  - Lot 29 (708m<sup>2</sup>)
  - Lot 30 (615m<sup>2</sup>)
  - Lot 33 (917m<sup>2</sup>)

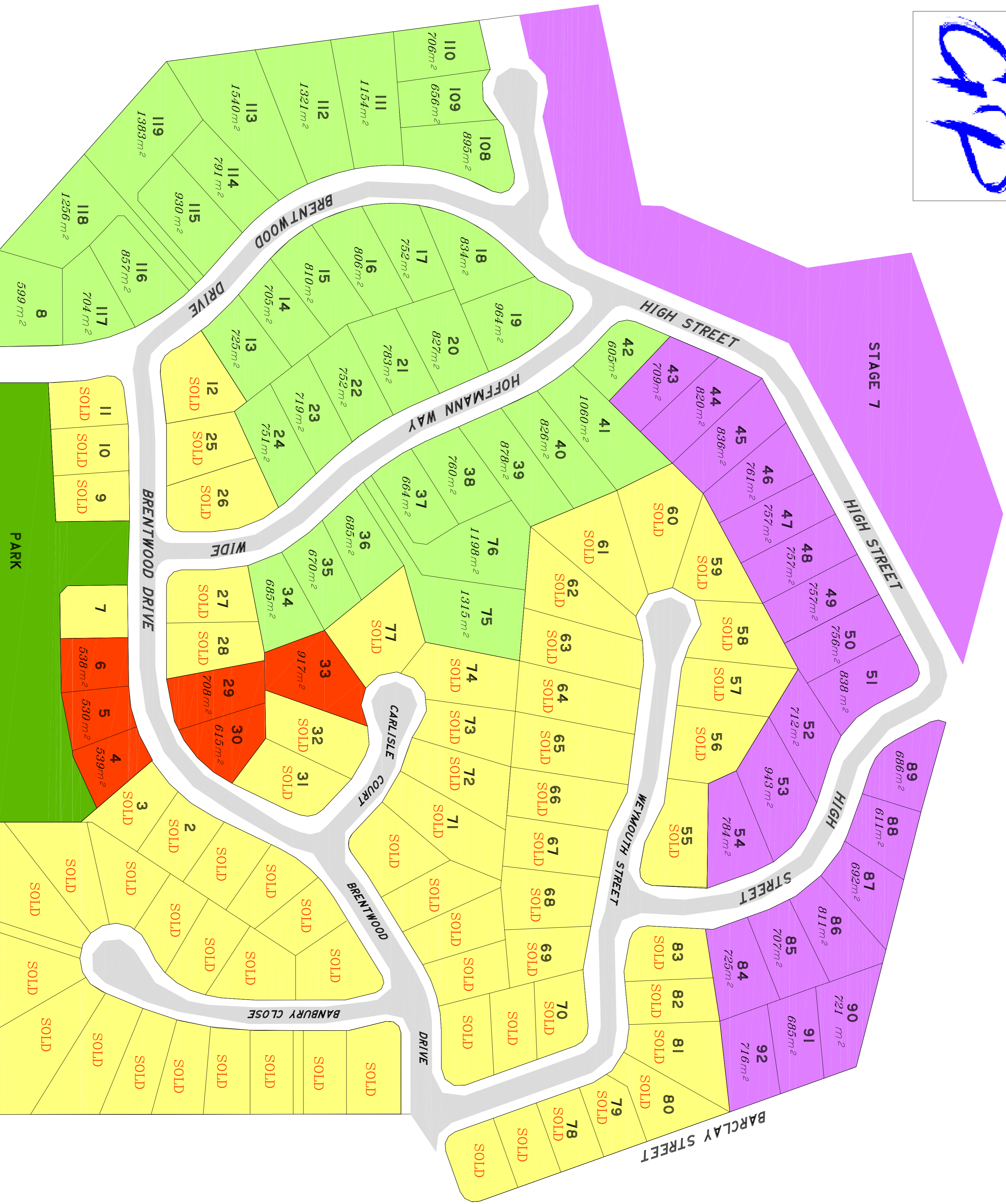

**NEXT STAGE**

- Pre-sale Options
  - Lots 8, 13, 14, 15, 16, 17, 18, 19, 20, 21, 22, 23, 24, 34, 35, 36, 37, 38, 39, 40, 41, 42, 108, 109, 110, 111, 112, 113, 114, 115, 116, 117, 118 and 119

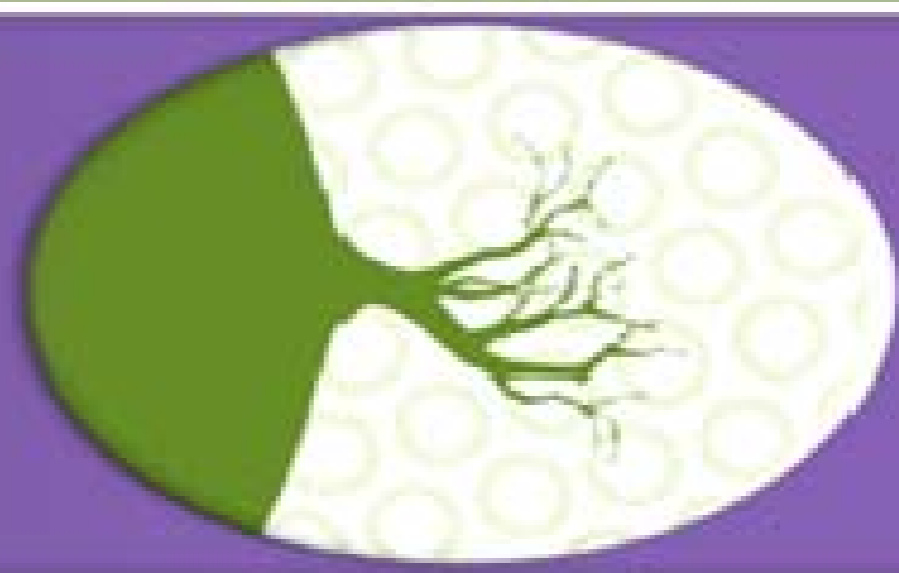

**FUTURE RELEASE**

- Stage 6: lots 43, 44, 45, 46, 47, 48, 49, 50, 51, 52, 53, 54, 84, 85, 86, 87, 88, 89 & 93
- Stage 6a: lots 90, 91 and 92
- Stage 7: further 14 residential lots